

EWC/FRD-PHV/120-01

FTH Rating - 1 or 2 Hours

Single Penetrations – Horizontal or Vertical

Concrete, Gypsum, Wood Floor / Gypsum Ceiling Assemblies

Tested to CAN/ULC-S115-95, ASTM E-814, UL-1479

Rated for use with Quickstop Quickwrap™ ONE Duct Wrap Material ONLY
(from EW+C – No Substitutes)

Maximum Annular Space of 7 ½”

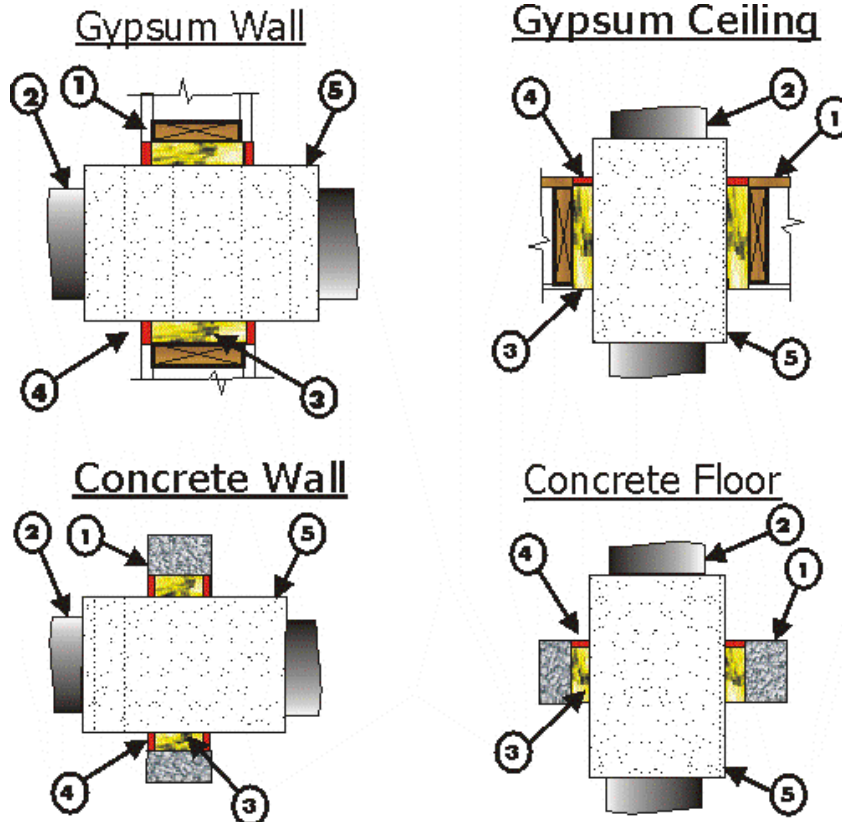

1. **Floor or Wall Assemblies:** Code conforming 1 or 2-hour floor or wall assembly. Minimum 4 ½” thick lightweight or normal weight concrete, 8” thick concrete block (filled or unfilled), 1 or 2 hour gypsum wall assembly with framed opening, 1 or 2 hour gypsum ceiling / wood floor assembly with framed opening.
2. **Penetrating Item:** Rectangular or Round #26 gauge or thicker steel air duct or #16 gauge grease duct
3. **Firestop System Component 1:** Quickstop *Quickwrap™ ONE* duct insulation, or mineral wool insulation tightly compacted a minimum of 4” into concrete opening, recessed ¼” from the top and flush with the bottom of a gypsum ceiling / wood floor assembly, or recessed ¼” from both sides of a concrete or framed gypsum wall assembly.
4. **Firestop System Component 2:** Quickstop Acrylic Latex Firestop Sealant installed a minimum of ¼” deep flush with the top surface of a floor assembly or both sides of a wall assembly.
5. **Firestop System Component 3:** Duct may be wrapped with Quickstop *Quickwrap™ ONE* Duct Wrap, or bare with *Quickwrap™ ONE* Duct Wrap abutting both sides of firestop assembly through concrete slabs or walls only.

* **Components bearing the Warnock Hersey Certification Mark**